

ELEVATION

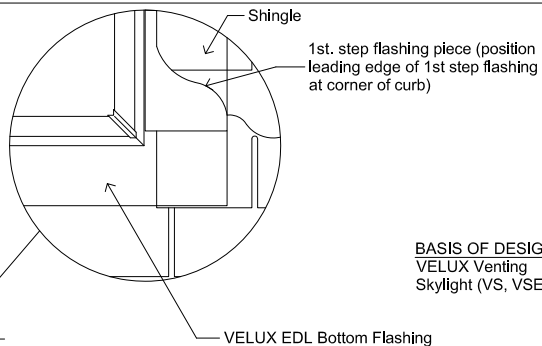

BASIS OF DESIGN:
VELUX Venting
Skylight (VS, VSE)

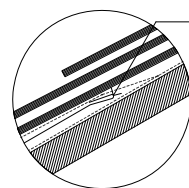

VELUX EDL Head Flashing
placed between underlayment

VELUX EDL Head Flashing
placed between underlayment

Sheathing

Underlayment

60-150 mm

Insulation -
place carefully
around window

Headers or blocking
as required per code(s)

Horizontal soffit lining

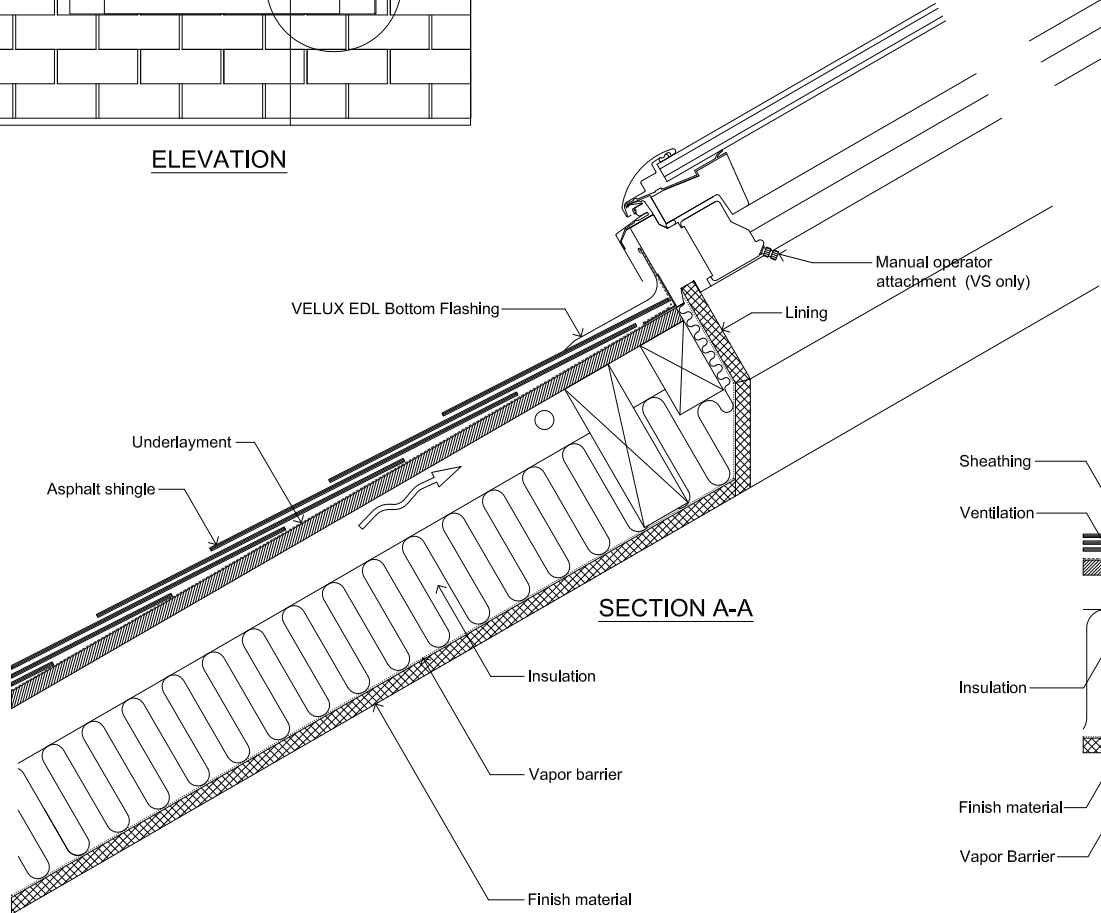
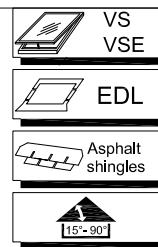

SECTION A-A

EDL-flashing gutter
Fixing angle bracket
attached to roof structure
with fasteners supplied
with skylight

Sheathing

Ventilation

Insulation

Finish material

Vapor Barrier

BASIS OF DESIGN:
VELUX Venting
Skylight (VS, VSE)

6 mm Max.
1/4" Max.



VELUX EDL
Step flashing
Asphalt shingle

SECTION B-B

Underlayment

VELUX EDL
Step flashing

Tight joint between finish
groove and finish material

Lining

Rafter

VELUX

Sky-Product Management

NEW ZEALAND LTD.

0800 650 445

VS, VSE - Venting Skylight and EDL flashing in Shingle Roof

	Name	Date
Drawn by		June 11
Checked by		June 11
Drawing No.		